





Hear the SoundStop® Difference

SOUND DEADENING SYSTEMS SELECTOR

SoundStop® Achieves Sound Transmission Class (STC) Ratings exceeding International Building Code® (IBC) Requirements.

STC Rating Scale

STC up to 60		SoundStop® + Fiberglass Batts + Resilient Channels + 5/8" Drywall	Superior sound proofing.
STC 50 (International Building Code® (IBC) require STC of 50)*		SoundStop® + 5/8" Drywall	Loud speech not audible. Vibration noise significantly reduced.
STC up to 44		Double Layer 5/8" Drywall	Some loud speech heard. Vibration noise not reduced.
STC up to 39 (Privacy begins at STC of 40)		Fiberglass Batts + 5/8" Drywall	Loud speech is still heard. STC rating fairly unchanged with addition of batts. Vibration noise not reduced.
STC up to 35		Single layer 5/8" Drywall	Loud speech clearly heard. Vibration noise heard with single or double layer of drywall.

*IBC Sections 1207.2 & 1207.3

The Gypsum Association has determined the addition of fiberboard panels such as SoundStop® will not have a negative impact on the fire rating of the wall system.

STC 50

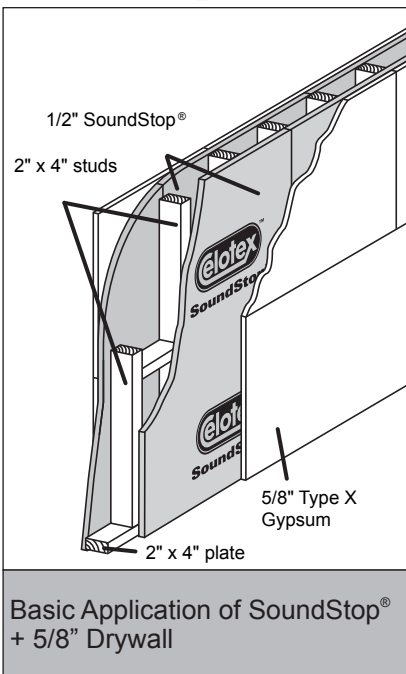

STC up to 54

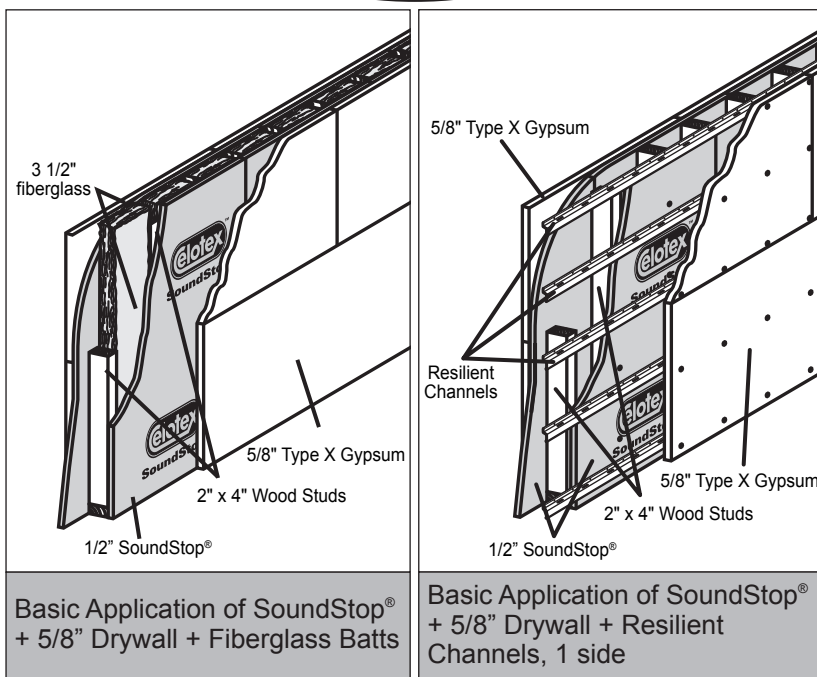

Basic system STC Rating of 50 is derived from Knight-Celotex data obtained under controlled test conditions in accordance with ASTM E90 (STC). Additional assemblies determined by calculating point additions for added materials, as detailed in test information.

See back for additional wall and ceiling applications.

STC up to 57

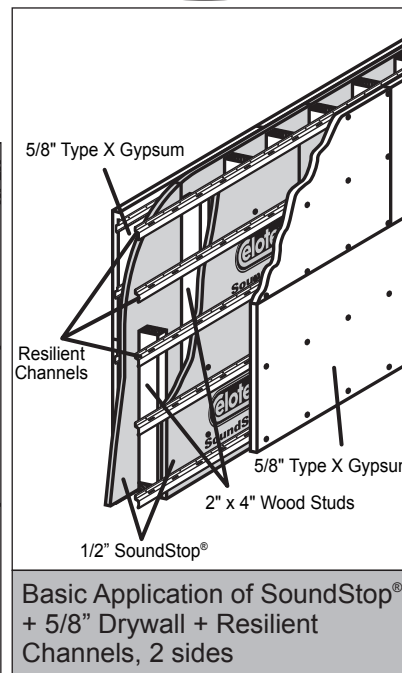

Product Orders and Customer Service:
1.800.375.0289
Technical Support:
1.800.596.9699
or visit us at:
www.knightcelotex.com

STC up to 60

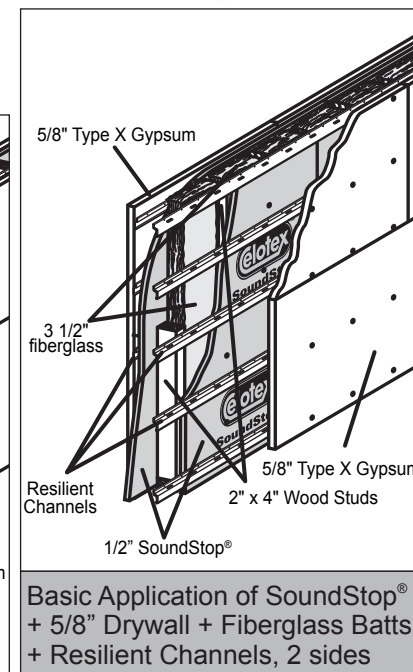

Knight-Celotex Fiberboard
a Knight Company

Innovations in Fiber Technology®

Trusted sound deadening expert
for more than 50 years.

Hear the SoundStop® Difference

SOUND DEADENING SYSTEMS SELECTOR

STC: 46

Wood Studs

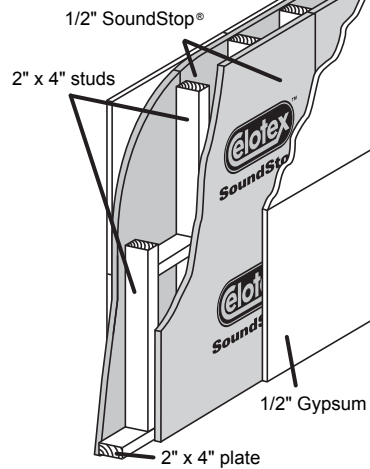

Framing: 2" x 4" studs, 16" o.c. 2" x 4" plates.

Inner Board: Vertical SoundStop® on both sides. Fastened by 5d coated nails 12" o.c. at edges and intermediately, heads dimpled. Joints staggered.

Outer Facing: Gypsum board applied horizontally to both sides; vertical joints staggered. Joint compound applied to back of board in 6" strips (using metal spreader having 3/16" triangular notches 1/2" apart) around perimeter and along horizontal centerline. Each unit also fastened by 8d doubleheaded nails, 24" o.c., for removal after laminated cement dries overnight. Joints tapered and cemented.

STC: 51

Wood Studs

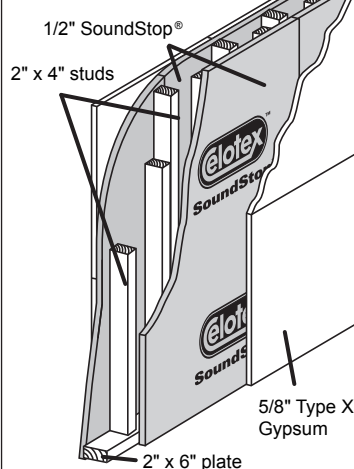

Framing: 2" x 4" studs, 16" o.c. staggered. 2" x 6" top and bottom plates.

Inner Board: 1/2" SoundStop® applied vertically to outside of studs. Fastened 12" o.c. along edges and intermediately by 5d coated nails, heads dimpled.

Outer Facing: 5/8" Type X tapered edge gypsum board applied vertically over SoundStop®; joints offset 16" to SoundStop® joints. Joint compound, as laminating compound, applied to back of board in 6" wide strips around perimeter, 2" from edges, and along vertical centerline. Gypsum board blocked temporarily around perimeter until compound sets. Joints taped and cemented.

STC: 44

Metal Studs

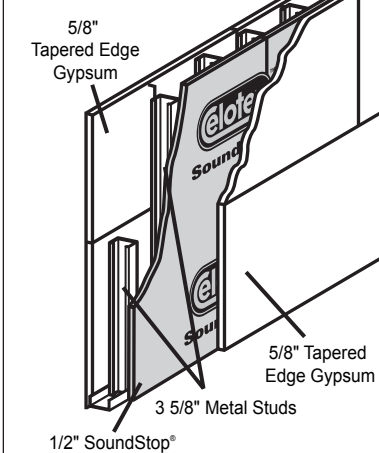

Framing: 3 5/8" metal stud, 24" o.c. Metal tracks.

Inner Board: Vertical SoundStop® on one side of studs; fastened by 1" drywall screws 16" o.c. along edges and intermediately.

Outer Facing: 5/8" gypsum board fastened vertically on one side of studs directly to framing with 1" drywall screws 8" o.c. along edges, 12" o.c. intermediately. On other side over SoundStop®, 5/8" gypsum board staggered 24" to Soundstop® joints; laminated and fastened by 1 5/8" drywall screws 8" o.c. along top and bottom edges, 32" o.c. intermediately. Joints taped and cemented.

STC: 49

Metal Studs

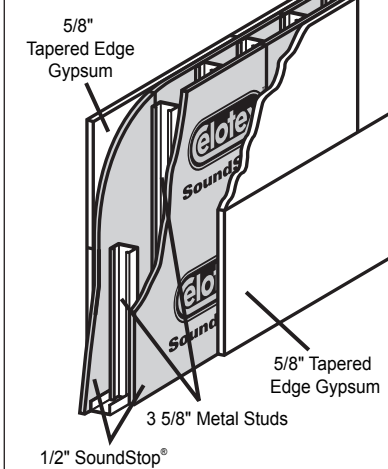

Framing: 3 5/8" metal studs, 24" o.c. Metal track, floor and ceiling.

Inner Board: SoundStop® applied vertically to both sides of studs; fastened with 1" drywall screws 16" o.c. along edges and intermediately.

Outer Facing: 5/8" tapered edge gypsum board applied vertically to both sides of studs over SoundStop®; joints staggered on opposite sides and staggered 12" o.c. to SoundStop® joints. Laminated and fastened with 1 5/8" drywall screws 8" o.c. along top and bottom edges, 32" o.c. intermediately. Joints taped and cemented.

STC: 42

Ceiling Application

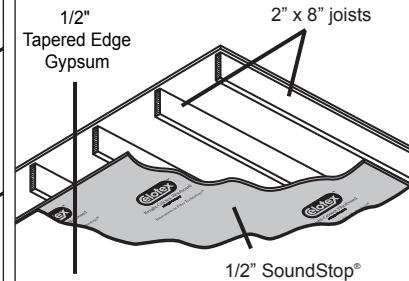

Framing: 2" x 8" joists, 16" o.c.

Flooring: 5/8" plywood subfloor 25/32" hardwood finish floor.

Ceiling: SoundStop® applied across framing. Fastened by 5d coated nails, 24" o.c., along edges and intermediately, nail heads dimpled. 1/2" tapered edge gypsum board applied over SoundStop® at right angles to board. Fastened by 1 3/4" GWB - 54 annular ring nails with 19/64" head, 7" o.c. joints tapered and cemented.

Product orders and Customer Service:

1.800.375.0289

Technical Support:

1.800.596.9699

or visit us at:

www.knightcelotex.com



Knight-Celotex Fiberboard
a Knight Company

Innovations in Fiber Technology®

Trusted sound deadening expert
for more than 50 years.